

### INTRODUCTION

The AW-IHH-0200 is a rugged Gigabit switch designed for critical and space-limited outdoor applications. Designed for IP surveillance, traffic monitoring, and security applications in critical environments, the converter can deliver a 95W output on Ethernet port, featuring an operating temperature ranging from -40°C to 75°C.

### PACKAGE CONTENTS

* 1x PoE switch	* 1x Quick Installation Guide
* 2x wall mount brackets	* 1x DIN rail bracket
* 1x 4-pin terminal block	

### ⚠ IMPORTANT:

1. Install the converter in a ventilated and dry place that is free of electromagnetic source, vibration, moisture, and dust.
2. Make sure the ventilation openings on the converter are not blocked.
3. Use fiber optic cables and transceiver compliant with the following: Multi-mode: 50/125um, 62.5/125um, 850/1310nm; Single-mode: 9/125um, 1310/1550nm.
4. DC input: 50V~56VDC. Follow the printed polarity for V+, V-, and Ground.
5. **Please DO NOT connect power to the V2 pins.**

### CONNECTION

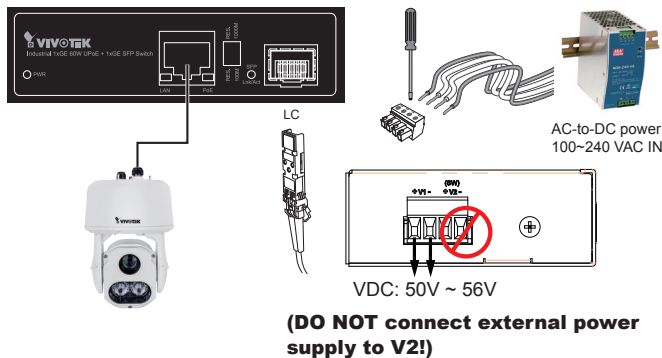

1. Pull out the 4-pin terminal block.
2. V1(power input): Connect positive wire of external power supply to V1 +, negative wire to V1 -, and neutral wires to the ground screw.
3. V2(relay output): Connect the 24VDC@1A pins to external devices, When 2 power pins are connected, the relay is shorted. When any of them is disconnected, the relay connection is open.
4. Connect an SFP transceiver to the fiber port.
5. install the 4-pin terminal block. You can connect redundant power line pairs for fault tolerance.

Solid or stranded (AWG): 12-24/14-22.  
Wire strip length: 7-8mm  
Torque: 5lb-In/0.5Nm/0.56Nm.

- WARNING** - Always ground the power source to maintain a clean power input.  
- Always shut off power source before connecting power wires.

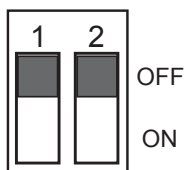

DIP 1	OFF	no use, reserved.
	ON	
DIP 2	OFF	1000Mbps speed for SFP port (default)
	ON	100Mbps speed for SFP port

### LED DEFINITIONS

<b>POWER</b>	Green ON	Power is on and normal.
<b>Fiber Link/Act</b>	Green ON	Fiber is attached.
	Green Flashing	Data is being transmitted / received.
<b>LAN port Green</b>	Green ON	TX link is detected.
	Green Flashing	Data is being transmitted or received.
<b>PoE port Amber</b>	Amber ON	PSE is activated and PD is detected.
	Amber Flasing	PSE data is being transmitted or received.

All specifications are subject to change without notice.  
Copyright © 2016 VIVOTEK INC. All rights reserved.