

Quick Installation Guide

English | 繁體中文 | 簡體中文 | 日本語 | Français | Español | Deutsch | Português | Italiano | Türkçe | Polski | Русский | Česky | Svenska | العربية

FD8162

2 MP • PIR • Focus Assist

Network Camera



SUPREME
A NEW DEFINITION OF HD

 **VIVOTEK**



Warning Before Installation

- **Power off the Network Camera as soon as smoke or unusual odors are detected.**
- **Keep the Network Camera away from water. If the Network Camera becomes wet, power off immediately.**



Contact your distributor in the event of occurrence.



Contact your distributor in the event of occurrence.

- **Do not place the Network Camera around heat sources, such as a television or oven.**
- **Refer to your user's manual for the operating temperature.**

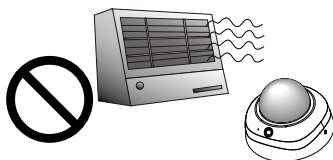
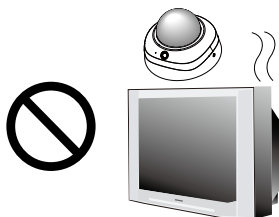

- **Keep the Network Camera away from direct sunlight.**
- **Do not place the Network Camera in high humidity environments.**

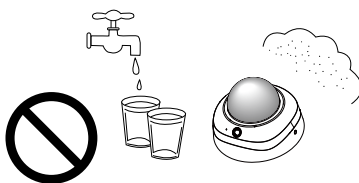
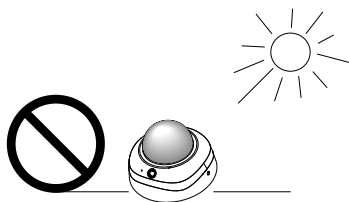

● Do not place the Network Camera on unsteady surfaces.

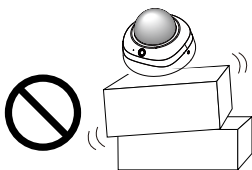

● Do not touch the Network Camera during a lightning storm.

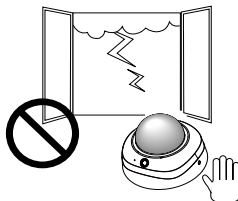

● Do not disassemble the Network Camera.

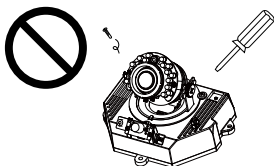

● Do not drop the Network Camera.

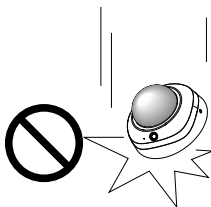

● Do not insert sharp or tiny objects into the Network Camera.

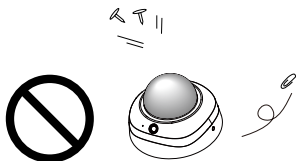

1 Package Contents

● FD8162

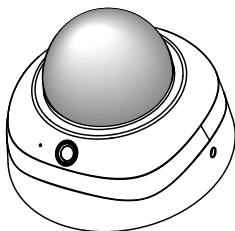

● Alignment Sticker

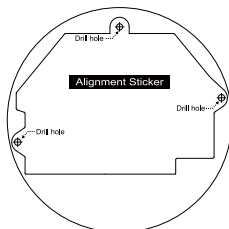

● Software CD



● T10 Torx Screwdriver/ Screws / Plastic Anchors

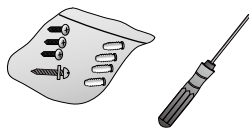

● Quick Installation Guide / Warranty Card



● DC Power Adapter (Optional)

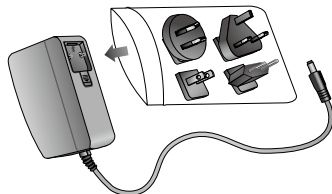

Camera Front View

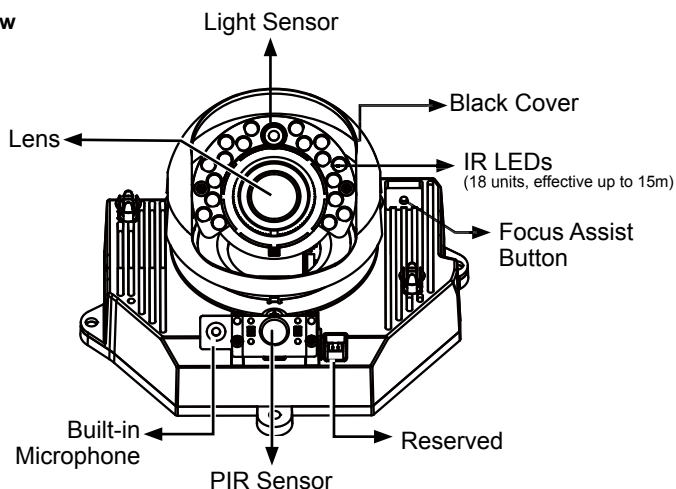

Camera Rear View

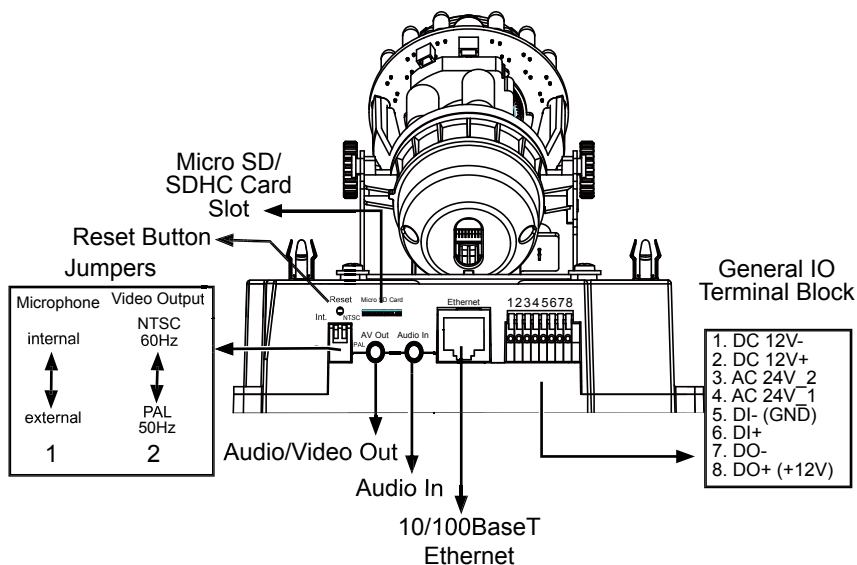

3 Hardware Installation

Before installing your camera, make sure the built-in PIR (Passive Infrared Sensor) can be directed toward the area of interest, where possible intrusion may occur. (The sensitivity of PIR sensor depends on the object size and temperature differences between the object and the background environment.)

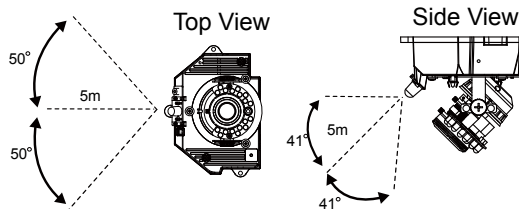

Use the included T10 Torx screwdriver to loosen screws on the sides of dome cover to remove it. You should then jot down the MAC address printed on the bottom of the camera.

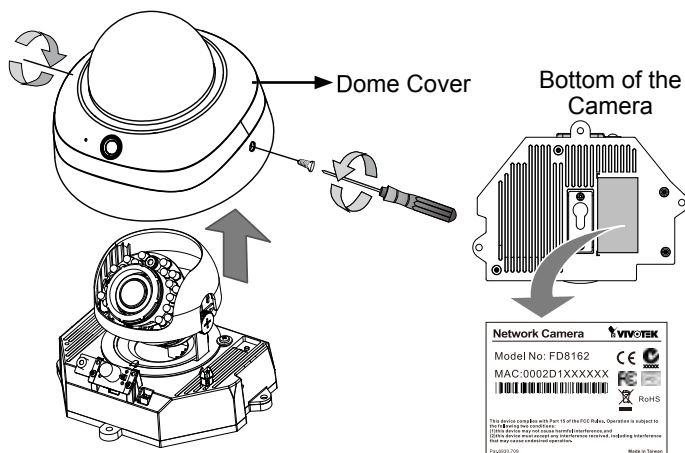

Remove the black cover as shown below so that you can fine-tune the focus and zoom the camera later when the cabling is done.

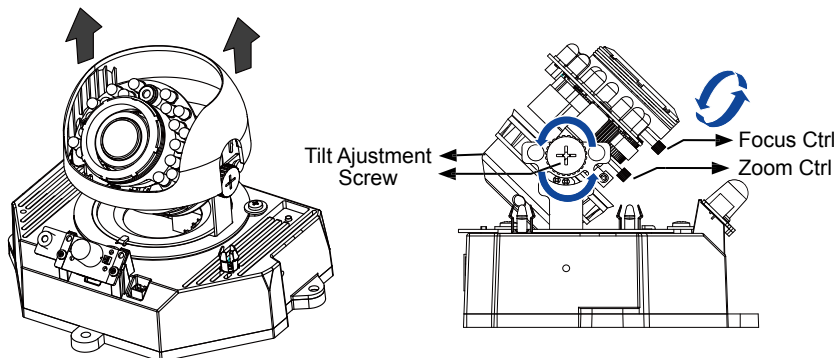

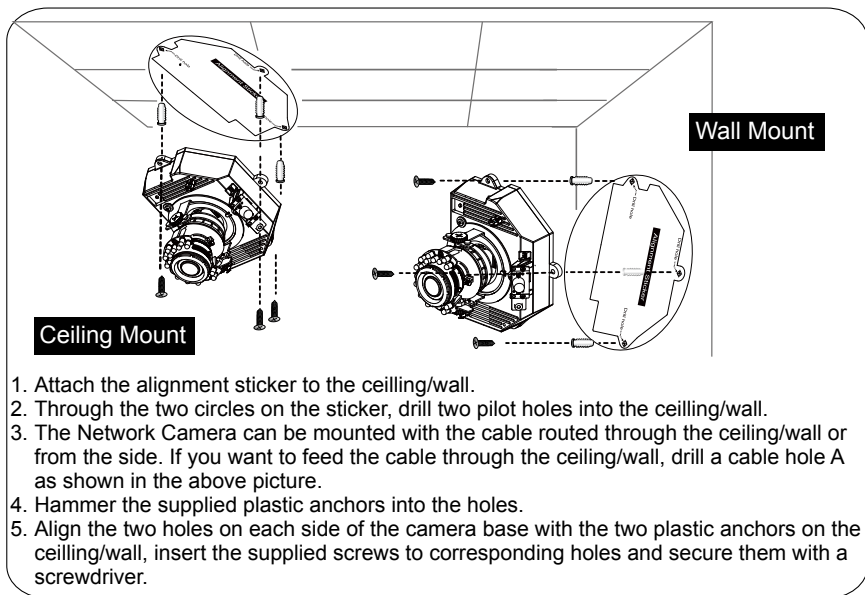

4 Network Deployment

General Connection (without PoE)

1. If you have external DI devices, make the connection from general I/O terminal block.
2. Ethernet, power, and other cables are user-supplied. Use a Category 5 Cross Cable when Network Camera is directly connected to PC.
3. Connect either the DC or AC pins from the terminal block to a power outlet.

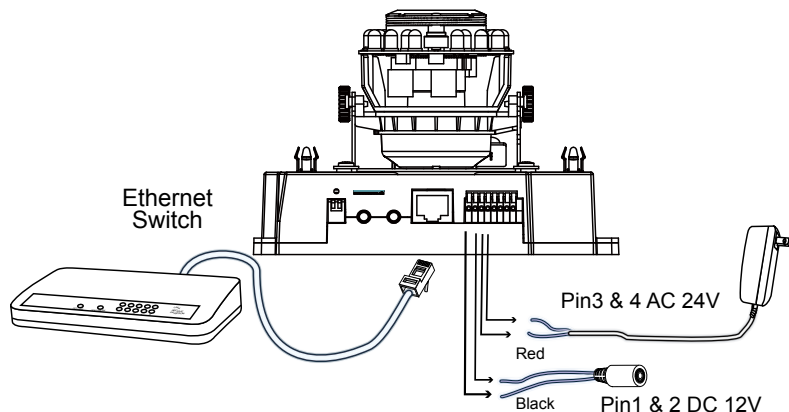

Power over Ethernet (PoE)

● **When using a PoE-enabled switch**

This Network Camera is PoE-compliant, allowing transmission of power and data via a single Ethernet cable. Follow the below illustration to connect the Network Camera to a PoE-enabled switch via Ethernet cable.

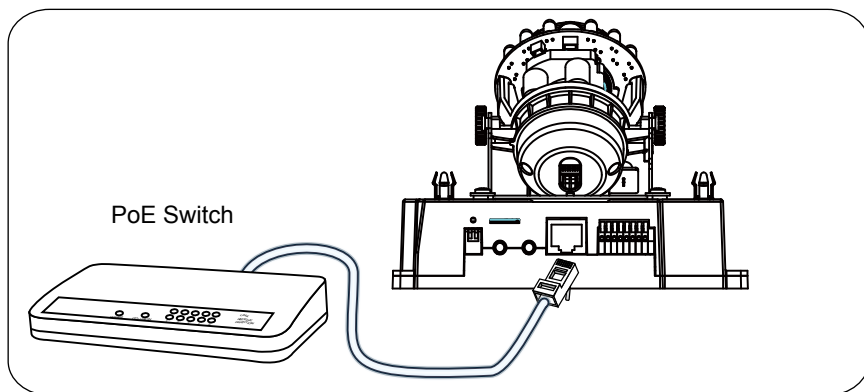

● **When using a non-PoE switch**

Use a PoE power injector (optional) to connect between the Network Camera and a non-PoE switch.

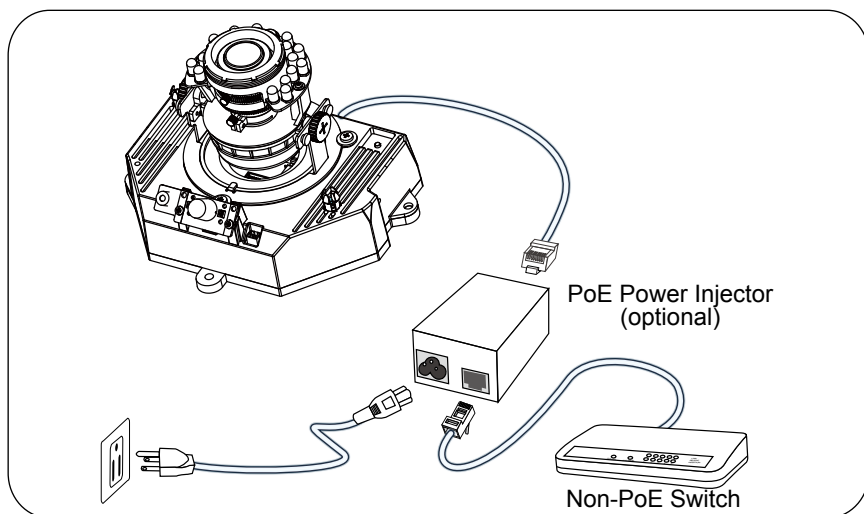

5 Assigning an IP Address

1. Install "Installation Wizard 2" from the Software Utility directory on the software CD.
2. The program will conduct an analysis of your network environment. After your network is analyzed, please click on the "Next" button to continue the program.

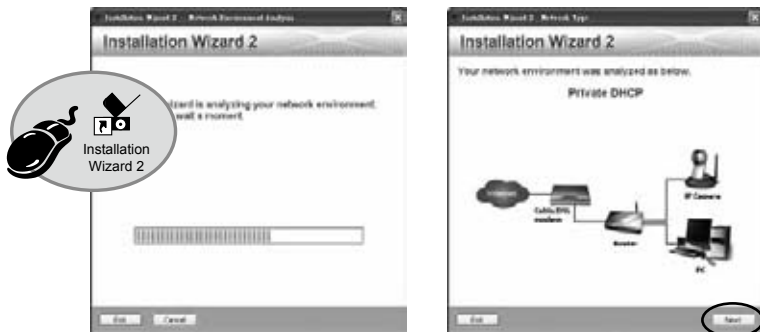

3. The program will search for VIVOTEK Video Receivers, Video Servers, and Network Cameras on the same LAN.
4. After a brief search, the main installer window will pop up. Double-click on the MAC address that matches the one printed on the camera label or the S/N number on the package box label to open a browser management session with the Network Camera.

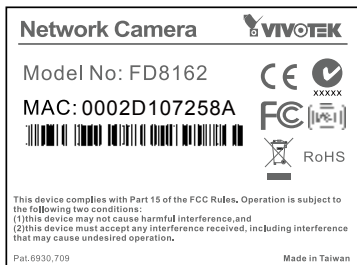

6 Ready to Use

1. A browser session with the Network Camera should prompt as shown below.
2. You should be able to see live video from your camera. You may also install the 32-channel recording software from the software CD in a deployment consisting of multiple cameras. For its installation details, please refer to its related documents.

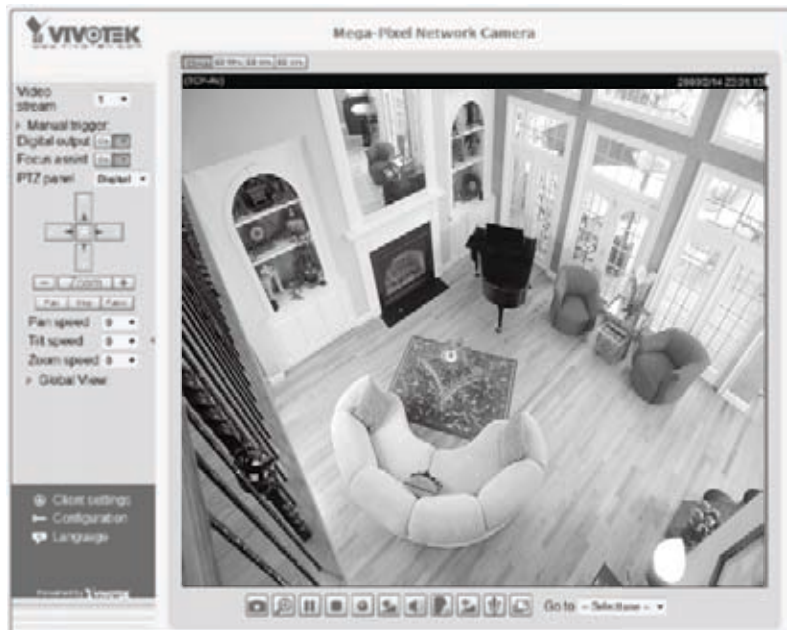

For further setup, please refer to the user's manual on the software CD.

Based on the live image retrieved from the camera, adjust the camera lens to the desired view angle:

1. Turn the lens module left and right.
2. Loosen the tilt adjustment screws on both sides of the camera and then turn the lens module up and down. Upon completion, tighten the screws.
3. Turn the lens to adjust the image orientation.

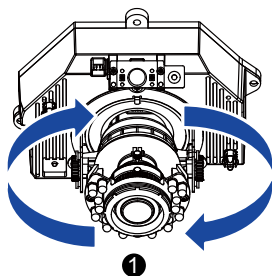

Pan 350°

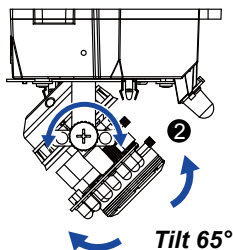

3-axis Mechanism Design

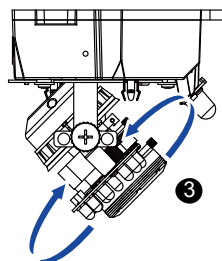

Rotate 350°

The sophisticated 3-axis mechanism design offers very flexible, easy hardware installation for either ceiling or wall mount.

To adjust the zoom factor and focus range

1. Loosen the zoom controller and then adjust zoom factor by moving the controller left and right. Upon completion, tighten the zoom controller screw.
2. Loosen the focus controller and then adjust focus range by moving the controller left and right. Upon completion, tighten the focus controller screw.

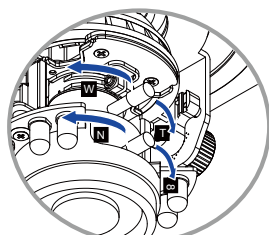
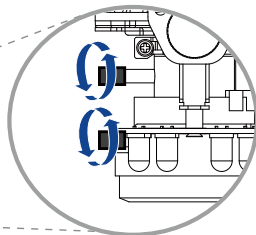
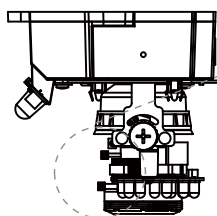

DO NOT over-tighten the controller bars. Doing so will damage the camera lens module.

8 Completion

1. Align the notches on the inner side of the black cover with the rivets on the sides of the lens, and then fix the black cover.
2. If you choose to feed the cable through the ceiling/wall, arrange the cables neatly through the cable hole A (not shown in the drawing). If you choose to feed the cable from the side, remove plate B.
3. Attach the dome cover to the camera as the direction shown below. Tighten two screws from the sides of the dome cover.
4. Finally, make sure all parts of the camera are securely installed.

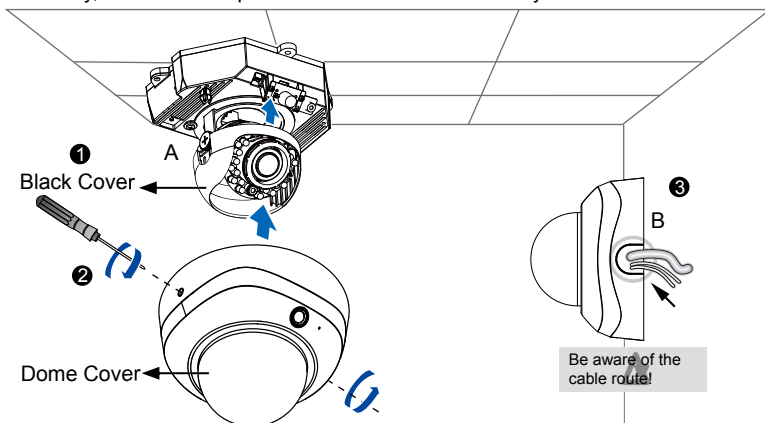

1. When mounting the camera, you can use the key hole slot at the bottom. The key hole slot helps facilitate installation and a safe mounting. First fasten a pioneer screw to the wall/ceiling. Mount the camera to the screw.
2. Use a pencil to mark the locations of the 3 permanent mounting holes.
3. When cabling and the initial adjustment is done, mount the camera by fastening screws to the 3 mounting holes.

