

Outdoor Day/Night Wide Dynamic Range
NETWORK CAMERA
Quick Installation Guide

English | 繁体中文 | 简体中文 | 日本語 | Français | Español | Deutsch | Português | Italiano | Türkçe | Polski | Русский | Česky | Svenska | العربية



IP7142

This guide describes the basic functions of IP7142.

All detailed information is described in the user's manual.



Warning Before Installation

- **Power off the Network Camera as soon as smoke or unusual odors are detected.**
- **Refer to your user's manual for the operating temperature.**



Contact your distributor in the event of occurrence.

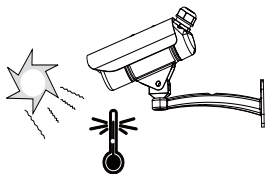

- **Do not place the Network Camera on unsteady surfaces.**
- **Do not touch the Network Camera during a lightning storm.**

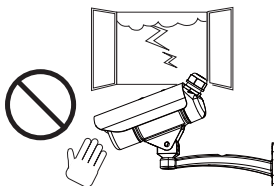
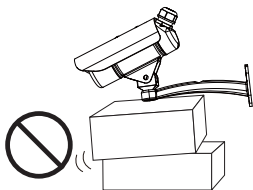

- **Do not insert sharp or tiny objects into the Network Camera.**
- **Do not drop the Network Camera.**

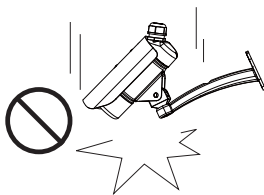
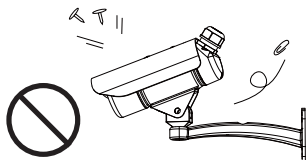

1

Package Contents

● IP7142

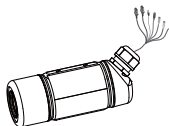

● Sun Shield



● Screws / RJ45 Female/Female Coupler



● Camera Stand

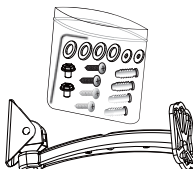

● Power Adapter

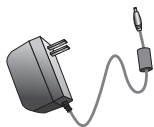

● Silica Gel



● Spanner



● Quick Installation Guide



● Warranty Card



● Software CD

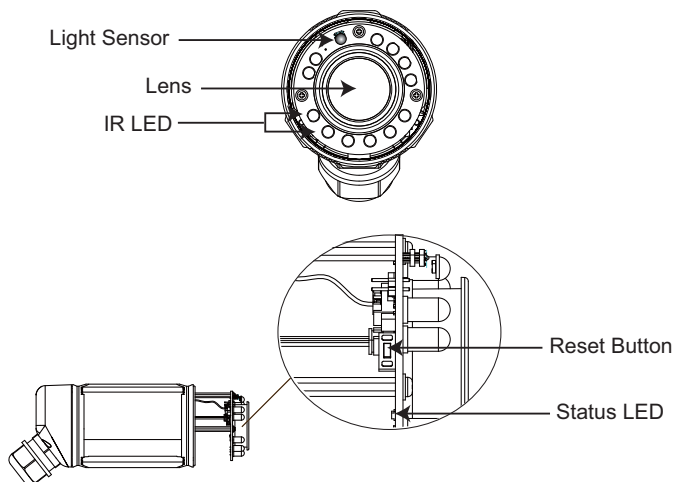
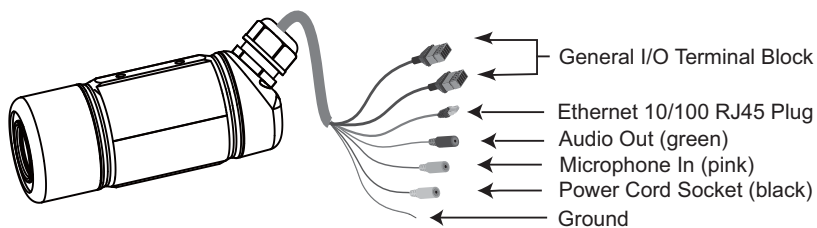

2

Physical Description**● Front Panel****● Connectors**

3

Hardware Installation

1. Open the lens cover.
2. Secure the Network Camera to the wall/ceiling by the supplied camera stand.

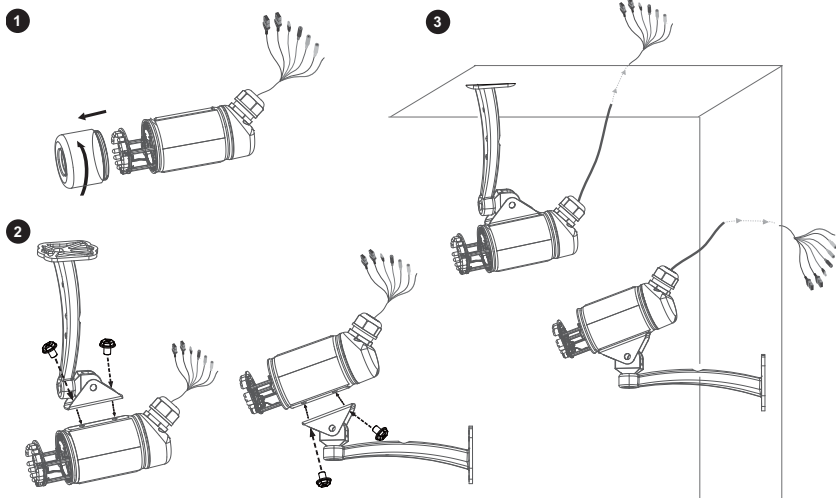

4

Network Deployment

General Connection (without PoE)

1. If you have external devices such as sensors and alarms, connect them to the general I/O terminal block.



N . C . : No Connector
 4 8 5 B : RS485-
 4 8 5 A : RS485+
 AC24V: Power in AC 24V
 AC24V: Power in AC 24V



G N D : Ground
 D I : Digital Input
 D O : Digital Output
 + 1 2 V : Power, 12V DC

2. Use the supplied RJ45 female/female coupler to connect the Network Camera to a switch.

Use Category 5 Cross Cable when Network Camera is directly connected to PC.

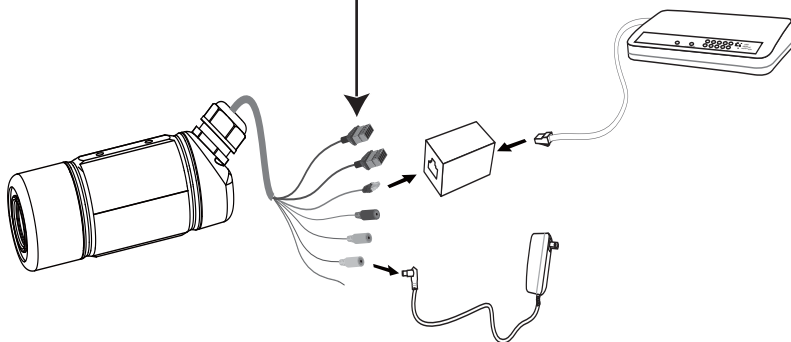

3. Connect the power cable from the Network Camera to a power outlet.

Power over Ethernet (PoE)

● When using a PoE-enabled switch

The Network Camera is PoE-compliant, allowing transmission of power and data via a single Ethernet cable. Follow the below illustration to connect the Network Camera to a PoE-enabled switch via Ethernet cable.

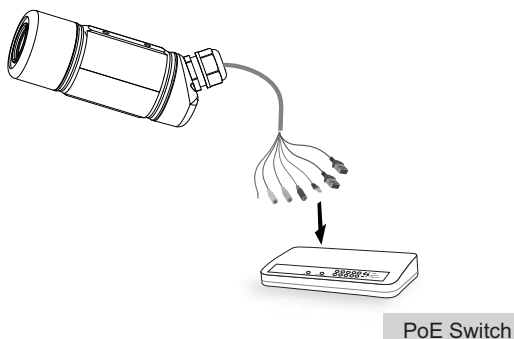

● When using a non-PoE switch

Use a PoE power injector (optional) to connect between the Network Camera and a non-PoE switch.

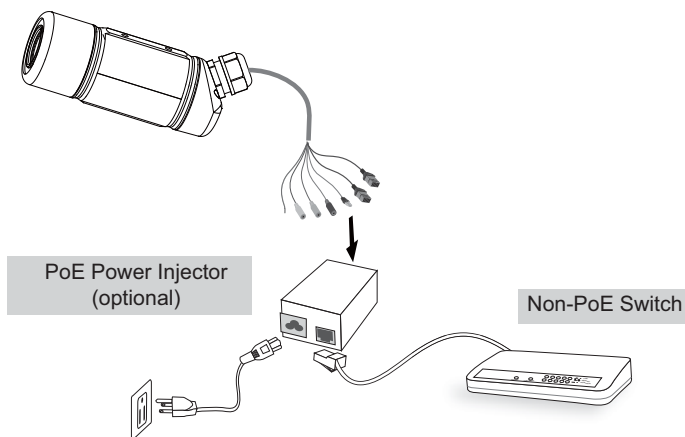

5 Assigning an IP Address

1. Install "Installation Wizard 2" from the Software Utility directory on the software CD.
2. The program will conduct an analysis of your network environment. After your network is analyzed, please click on the "Next" button to continue the program.

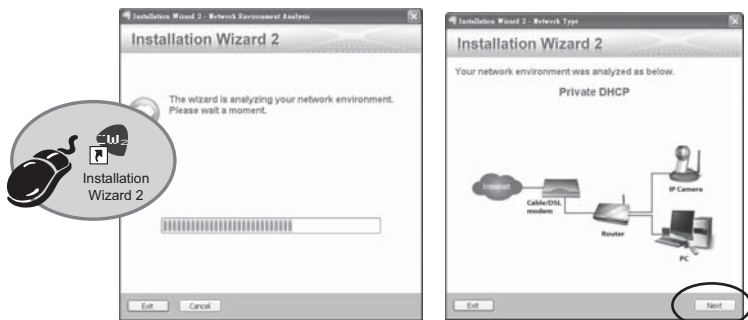

3. The program will search for VIVOTEK Video Receivers, Video Servers, and Network Cameras on the same LAN.
4. After searching, the main installer window will pop up. Click on the MAC that matches the one labeled on the side of the camera lens or S/N number on the label of carton to connect the Internet Explorer to the Network Camera.

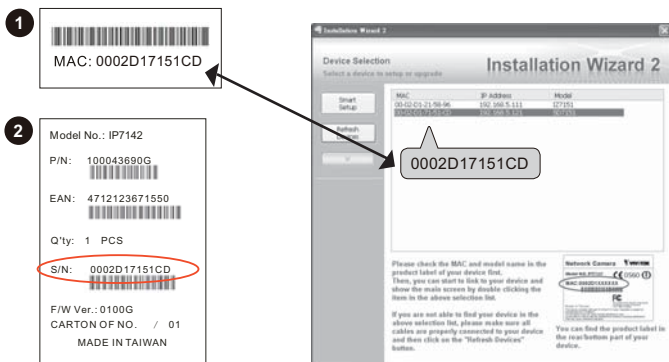

1. Access the Network Camera from the Internet.
2. Retrieve live video through web browsers or recording software.



For further setup, please refer to the user's manual on the software CD.

3. Unscrew the zoom controller to adjust the zoom factor. Upon completion, tighten the zoom controller.
4. Unscrew the focus controller to adjust the focus range. Upon completion, tighten the focus controller.

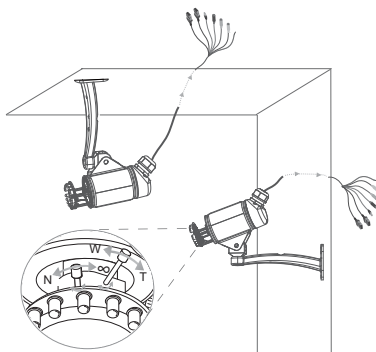

5. Tear down the aluminum foil vacuum bag and take out the silica gel. Attach the silica gel to the inner side of the Network Camera, then tighten the lens cover. (Please replace the silica gel with a new one if you open the back cover after installation.)

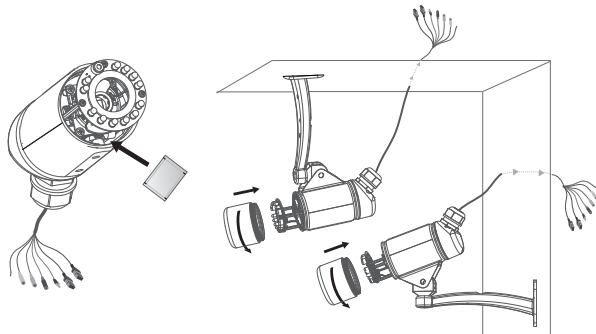

Note

If you want to use the supplied sun shield for outdoor environments, please follow the steps below to install:

1. Tighten the supplied two screws.
2. Attach the supplied sun shield to the Network Camera and slide it to the desired position.
3. Fix the sun shield with the supplied two screws. (Please use different screws for ceiling mount.)
4. Secure the Network Camera to the wall/ceiling by the supplied camera stand.

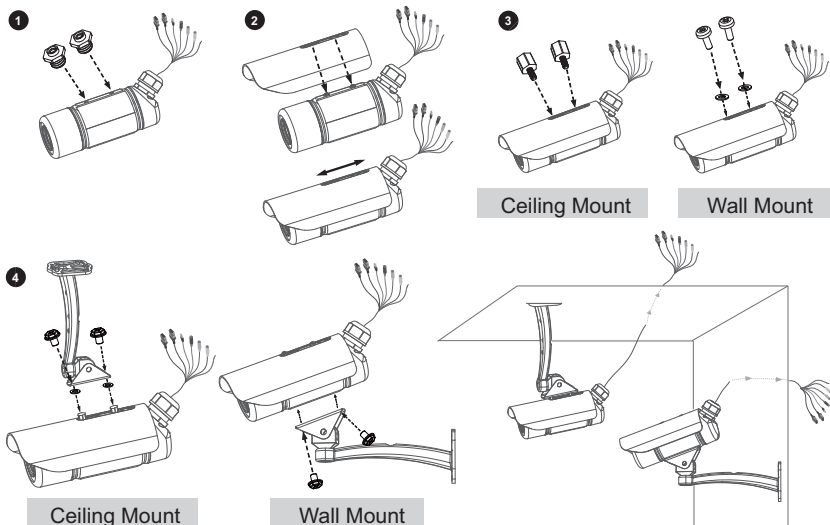



P/N: 625006201G Ver.2.0
Copyright © 2008 VIVOTEK INC. All right reserved.