



SF8172V Fixed Dome
Network Camera

Quick Installation Guide

English | 繁體中文 | 简体中文 | 日本語 | Français | Español | Deutsch | Português | Italiano | Türkçe | Polski | Русский | Česky | Svenska | Nederlands

Dansk | Indonesia | العربية

5MP • 360° Surround View • PoE • IP66 • Vandal-proof

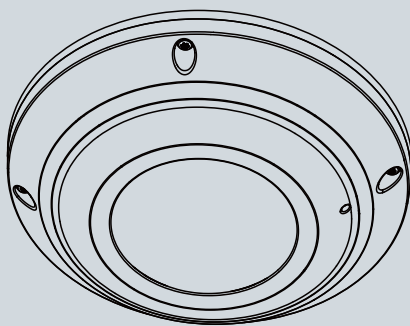

SUPREME



Warning Before Installation

- Power off the Network Camera as soon as smoke or unusual odors are detected.
- Do not place the Network Camera on unsteady surfaces.
- Do not insert sharp or tiny objects into the Network Camera.
- Refer to your user's manual for the operating temperature.
- Do not touch the Network Camera during a lightning storm.
- Do not drop the Network Camera.

1 Package Contents

SF8172V

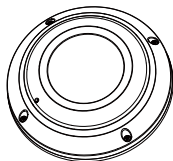

Mounting Plate / Screwdriver

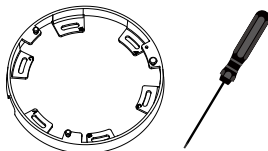

Alignment Stickers

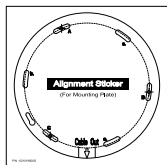

For Mounting Plate

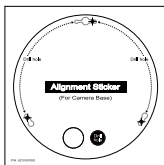

For Camera Base

Screws / Desiccant Bag / Double-sided Tape / Rubber Seal Plug / Rubber Washer



Quick Installation Guide / Warranty Card



Software CD



Power & I/O Cables



Inner View

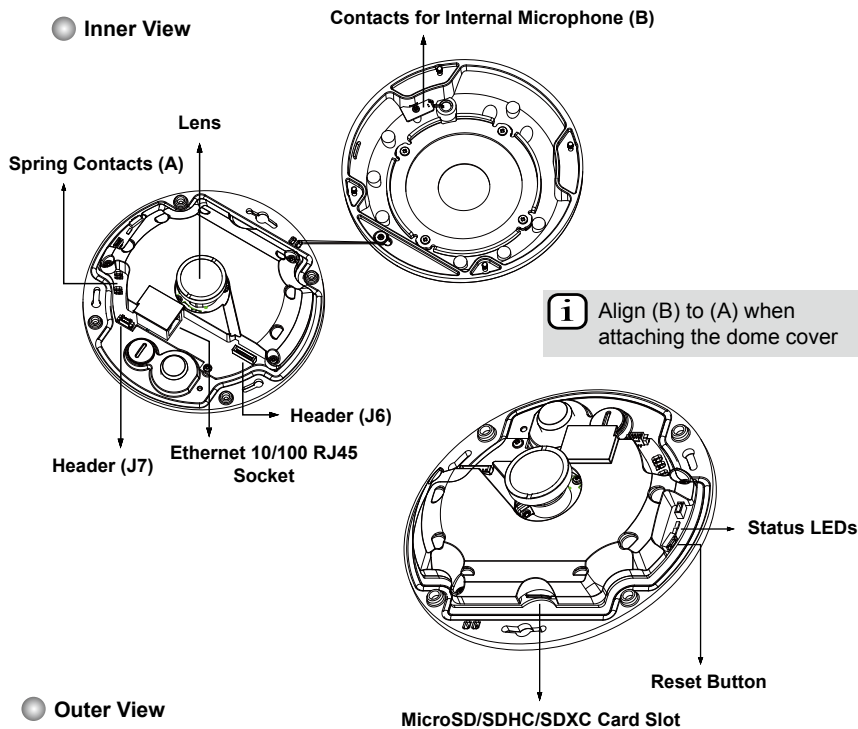

Outer View

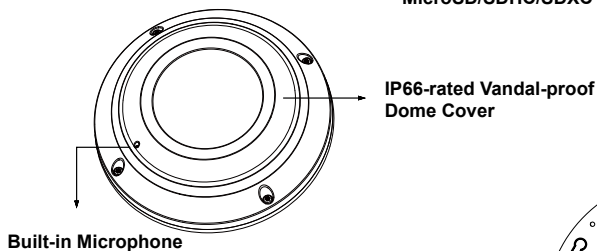

IMPORTANT:

Record the MAC address under the camera base before installing the camera.

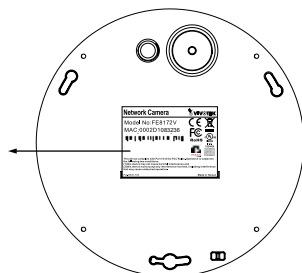

3

Hardware Installation

First, use the supplied screwdriver to loosen the four screws and detach the dome cover from the camera base. Then, follow the steps below to install the camera to either a ceiling or a wall.

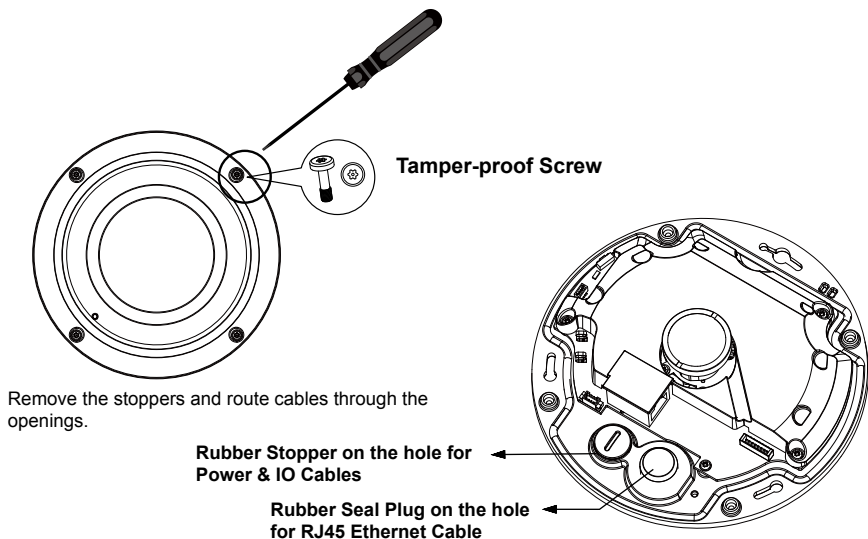

Connecting RJ45 Ethernet Cable

● RJ45 Cable Dimension (unit: mm)

Recommended cable gauge: 24AWG (0.51 mm)

● Assembly Steps

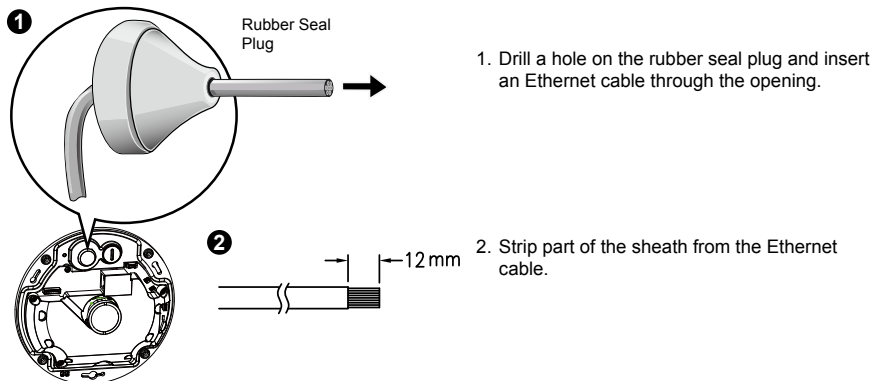

3

o: white/orange stripe
 O: orange solid
 g: white/green stripe
 B: blue solid
 b: white/blue stripe
 G: green solid
 br: white/brown stripe
 BR: brown solid

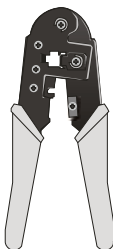
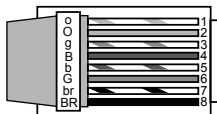

3. You will need an RJ45 crimping tool to attach the Ethernet wires to a connector. When done, connect the cable to the camera's Ethernet RJ45 socket.

4

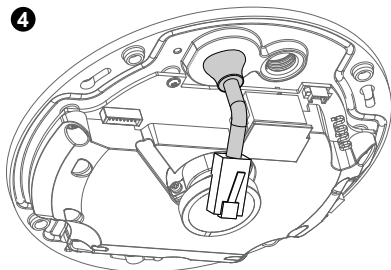

4. Feed the Ethernet cable from the bottom of the camera and through the hole. Attach the rubber seal plug for water proofing.

Connecting DC Power Cable

1. Add the supplied rubber washer to the cable as shown in the picture.
2. Feed the cable from the bottom of the camera and tighten the plastic base for waterproofing.

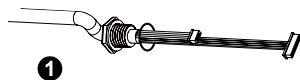

2

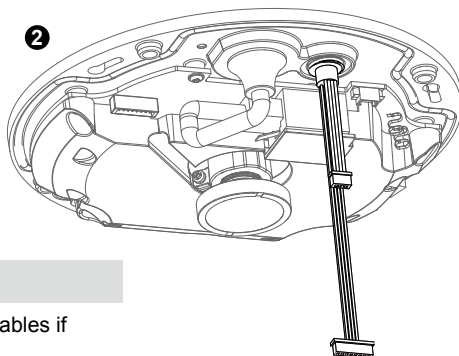

NOTE:

Connect the supplied power & IO cables if your switch does not support PoE.

IMPORTANT:

Refer to the **"Panoramic PTZ Installation Guide"** in your product CD for design considerations before you proceed with physical installation.

Attach Camera to Mounting Adapter

To attach the camera to AM-51A mounting adaptor,

1. Remove the camera's top cover.
2. Fasten 2 included screws to the D holes (not the D+ hole).
3. Route cables through the adapter.
4. Align the camera with the mounting adapter and let the 2 screws enter the key holes located on the sides where the camera's cabling interfaces reside, e.g., the Ethernet port.
5. Rotate the camera counter-clockwise. You can then see the D+ hole through the slotted screw hole (in front of the Micro SD slot).
6. Fasten screws to secure the camera to the mounting adapter.

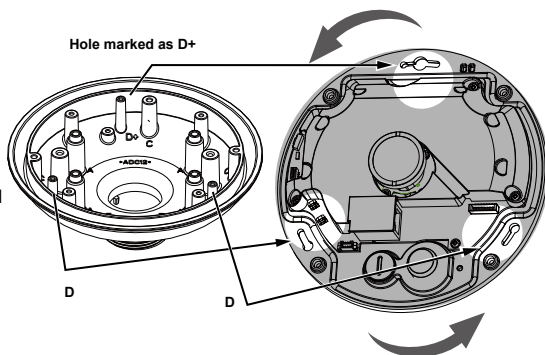

Ceiling Mount Installation

Install the Pendant Pipe

Below is a sample procedure using a pendant pipe:

1. Determine a hard surface ceiling location, and use the four mounting holes on the pendant head to mark the positions where holes will be drilled to secure the pendant head. Note that screws are user-supplied and they should be at least 11mm long.
2. Route cables through the pendant pipe and the pendant head.

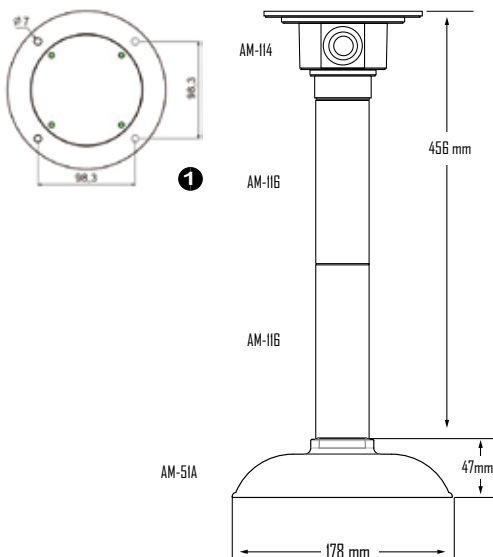

Install to the Ceiling

1. Drill pilot holes into the ceiling. Then hammer four anchors into the holes.
2. Secure the pendant head to the ceiling using four screws.
3. Connect the two white header connectors to the J6 and J7 connectors.
4. Connect the Ethernet cable to the RJ-45 socket.
5. You will find a desiccant bag attached to the camera. Replace the desiccant bag included in the camera with the one shipped within the accessory bag.
6. Attach the dome cover to the camera by driving its anti-tamper screws.
7. Route cables through a 3/4" conduit from the pendant head.

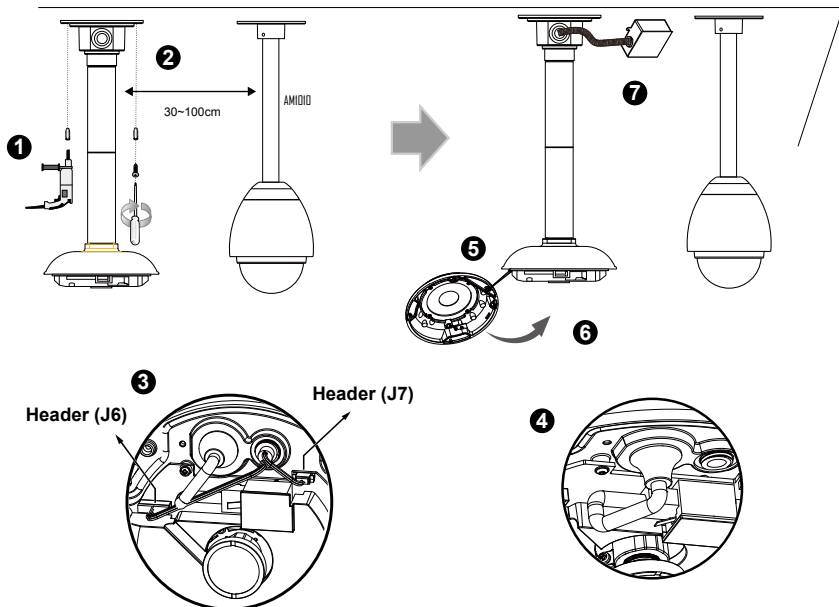

NOTE:

Arrange the cables neatly to avoid getting in the way when the dome cover is attached.

Wall Mount Bracket Installation

Below is a sample procedure using a wall mount bracket and a pendant pipe:

1. Determine a hard surface ceiling location. Use the four mounting holes on the wall mount bracket to mark the positions where holes will be drilled to secure the bracket and routing cables. Note that screws are user-supplied and they should be at least 11mm long.
2. Feed cables through the bracket.
3. Install the pendant pipe.
4. Install the camera to the mounting adapter. See [Attach Camera to Mounting Adapter](#) on the previous page.
5. Install the mounting adapter to pendant pipe.
6. Tighten the connection using the included hex wrench.

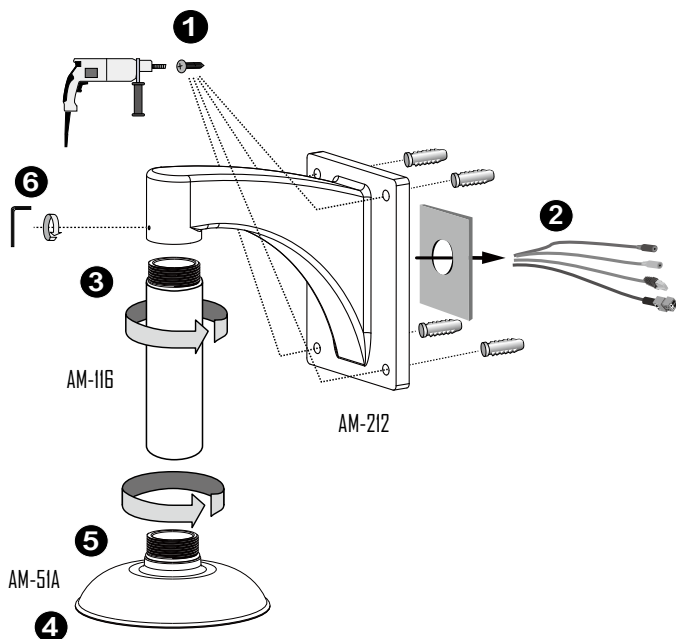

7. Install the speed dome camera next to the fisheye, with their lens positioned at approximately the same height. For details about speed dome installation, please refer to its documentation.
8. Connect all cabling, including the IO cables to J6 and J7, and the Ethernet cable to RJ-45 connector.
9. Install the dome cover by fastening the anti-tamper screws.

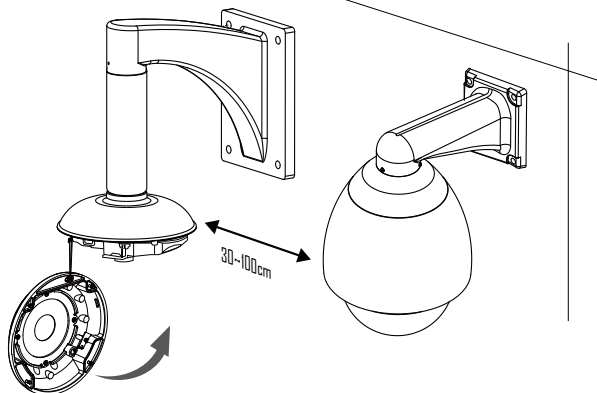

4 Network Deployment

General Connection (without PoE)

1. Connect RJ45 Ethernet cable to a switch.
2. Connect the power cable from the Network Camera to a power outlet.
3. If you have external devices such as sensors and alarms, make the connection from the general I/O terminal block.



NOTE:

If DC power is preferred, it should comply with: O/P: 12VDC, 1.5Amin., L.P.S. per IEC 60950-1.

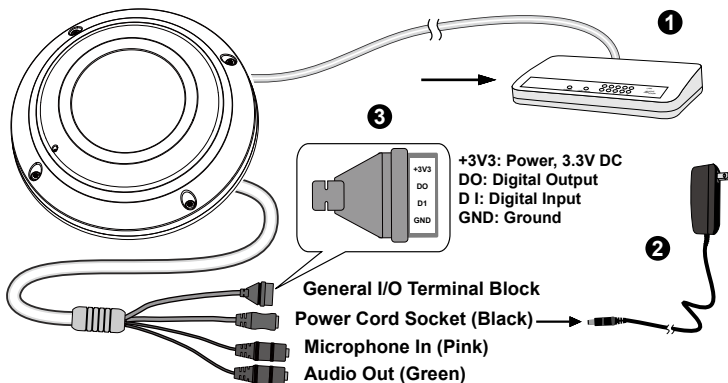

Power over Ethernet (PoE)

● When using a PoE-enabled switch

The Network Camera is PoE-compliant, allowing transmission of power and data via a single Ethernet cable. Follow the below illustration to connect the Network Camera to a PoE-enabled switch via Ethernet cable.



NOTE:

1. This equipment is only to be connected to PoE networks without routing to outside plants.
2. For PoE input connection, use only UL listed I.T.E. with PoE output.

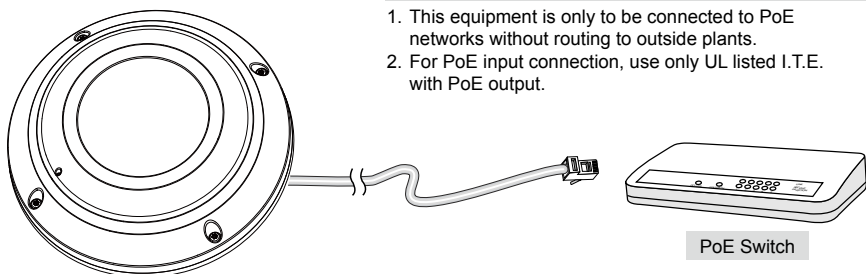

● When using a non-PoE switch

Use a PoE power injector (optional) to connect between the Network Camera and a non-PoE switch.

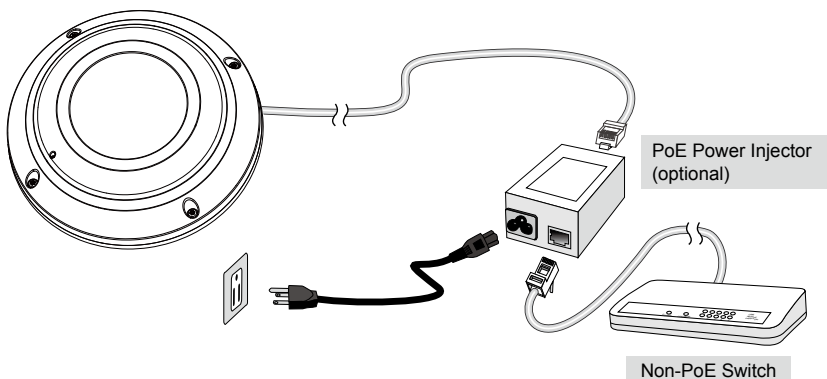

5 Assigning an IP Address

1. Install "Installation Wizard 2" from the Software Utility directory on the software CD.
2. The program will conduct an analysis of your network environment. After your network is analyzed, please click on the "Next" button to continue the program.
3. The program will search for VIVOTEK Video Receivers, Video Servers, and Network Cameras on the same LAN.
4. After a brief search, the main installer window will pop up. Double-click on the MAC address that matches the one printed on the camera label or the serial number on the package box label to open a browser management session with the Network Camera.

6 Ready to Use

1. A browser session with the Network Camera should prompt as shown below.



2. Refer to the "Panoramic PTZ Installation Guide" in your product CD for the rest of the configuration details.

NOTE:

If you encounter problems with displaying live view or the onscreen plug-in control, you may try to manually remove the plug-ins that might have been installed on your computer. Remove the following folder: C:\Program Files (x86)\Camera Stream Controller.

P/N:625021500G Rev.: 1.0

All specifications are subject to change without notice.
Copyright © 2013 VIVOTEK INC. All rights reserved.



VIVOTEK INC.

6F, No.192, Lien-Cheng Rd., Chung-Ho, New Taipei City, 235, Taiwan, R.O.C.
| T: +886-2-82455282 | F: +886-2-82455532 | E: sales@vivotek.com

VIVOTEK USA, INC.

2050 Ringwood Avenue, San Jose, CA 95131
| T: 408-773-8686 | F: 408-773-8298 | E: salesusa@vivotek.com